

Umi Smart Wireless LED Remote Controller

Model: BR03-1G

Function

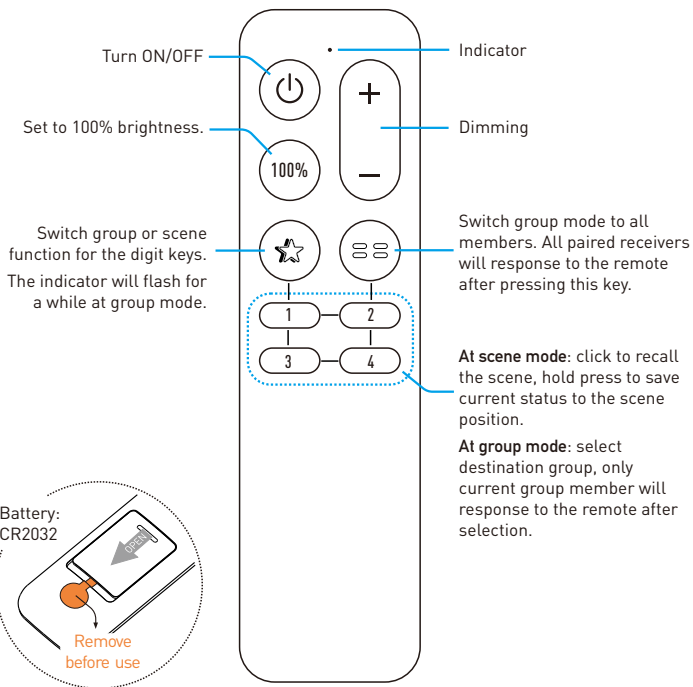

Operation

1. Pair and unpair the remote to receiver

The remote controller needs to be paired to receiver to work. User can pair up to 5 remote controllers to one receiver and each remote controller can be paired to any receiver.

To pair or unpair remote to the receiver, please operate with following steps:

- 1). Cut off the power of receiver and power on again after more than 5 seconds.
- 2). Press remote (⏻) and (+) key simultaneously and briefly within 10 seconds after receiver powered on.
- 3). Release all keys, then press (⏻) key or 1-4 digit key within 10 seconds to pair the remote to the receiver. For (⏻) key, the receiver will be paired without group feature, for 1-4 key the receiver will be paired to 1-4 target group.
- 4). To unpair the remote from receiver, do the step 1-2 first, then release all keys and press (★) key within 10 seconds.

2. Load and save scenes

The default function of 1-4 digit keys are for scene function. User can short press 1-4 key to load scene.

To save a scene, please adjust the favorite light status first, then hold press 1-4 digit key to save current status to relative scene position. After save operation, user can load the saved scene by short press the digit key.

3. Switch target group

To switch the target group, please press the (★) key first, then press the target group digit key. For example, to switch to group one, please press (★) then (1) key. The remote controller function will switch to the target group shortly. To restore the remote controller to all groups, please press (≡≡) key.

Specification

Working voltage	DC 3V, CR2032 battery
Wireless protocol	Umi protocol based on SIG BLE Mesh
Frequency band	2.4GHz ISM band
Wireless power	< 7dBm
Working temperature	-20-55°C(-4-131°F)

Umi智能无线

LED遥控器

型号: BR03-1G

功能

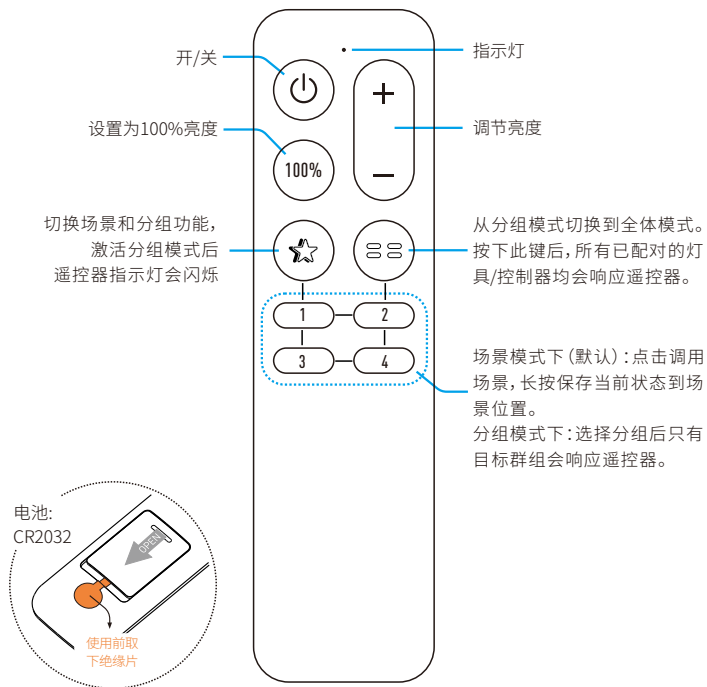

操作方法

1. 配对到灯具或控制器

遥控器需要与灯具或控制器配对才能工作。一个灯具或控制器最多可以配对5个遥控器, 遥控器则可以与任意灯具或控制器配对。

请按以下步骤操作来完成遥控器配对或取消配对:

- 1). 将目标灯具或控制器断电, 在超过5秒后再通电。
- 2). 在灯具或控制器通电后的10秒内, 同时短按遥控器上的 与 键。
- 3). 松开所有按键, 然后在10秒内按 键或1到4任意数字键。如果按下 键, 灯具或控制器会与遥控器配对但不会被分配到任何分组; 如果按下1到4号数字按键, 灯具或控制器会与遥控器配对且被分配到相应数字的分组。
- 4). 若要取消遥控器与控制器的配对, 请先执行步骤 1-2, 然后松开所有键并在10秒内按下 键。

2. 调出和保存场景

1-4 数字键的默认功能为场景功能。用户可以短按1-4 键调出已保存的场景。

若要保存场景, 请长按1-4数字键将当前灯光效果保存到相应的场景位置。保存场景后, 可以通过短按数字键加载保存的场景。

3. 切换目标群组

要切换分组, 请先按 键, 然后随即按下目标组数字键。例如, 要切换到第一组, 请按 再按 键, 遥控器的所有控制功能将切换到分组1。要将遥控器切换到所有灯具或控制器, 请按下 键。

规格

工作电压	DC 3V, CR2032纽扣电池
无线协议	Umi协议, 基于 SIG BLE Mesh
频段	2.4GHz ISM band
无线功率	< 7dBm
工作温度	-20-55°C (-4-131°F)

Rayrun